



ЕНЕРДЖИ ГРУП ООД

Капащи на кабелни скари и аксесоари



Системи за електрически кабелни скари

**LIDS OF CABLE TRAY
SYSTEMS**



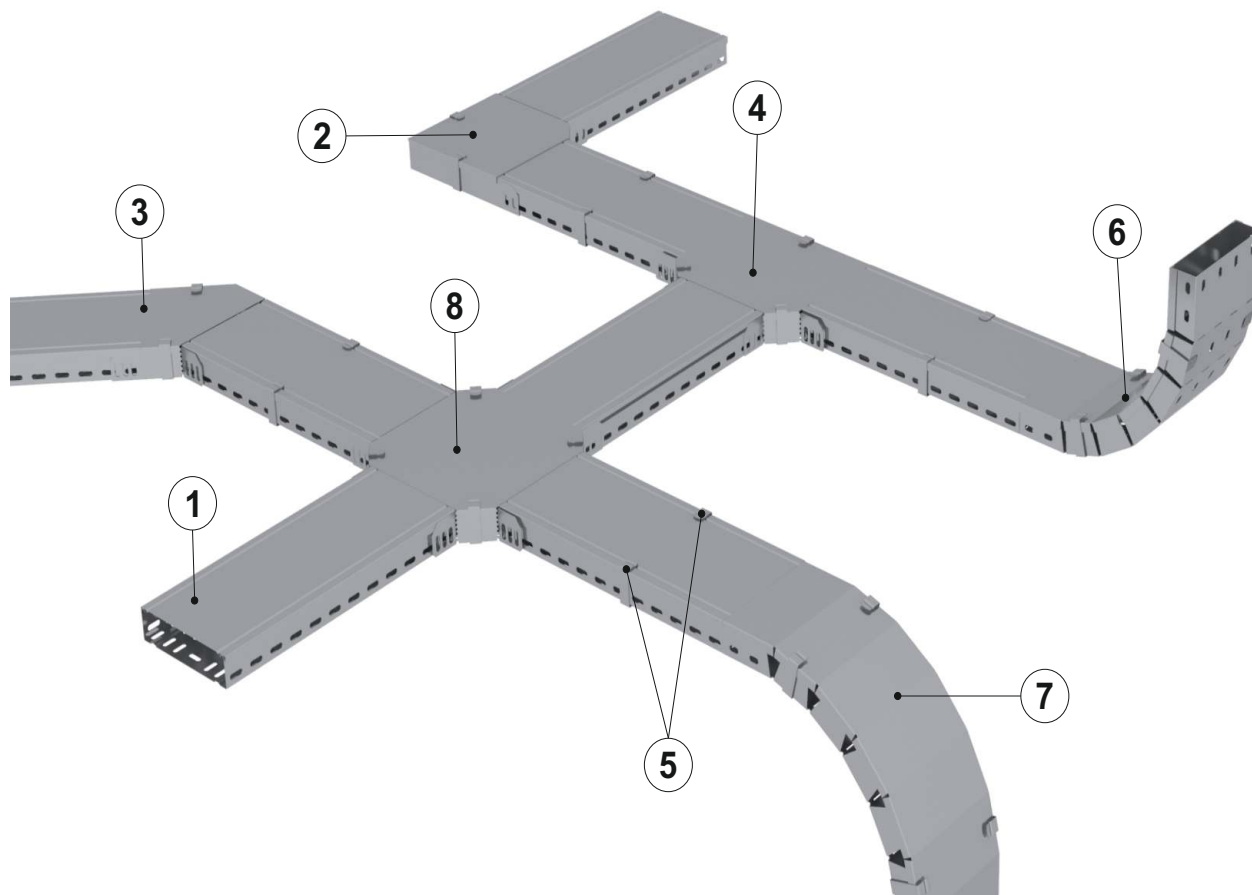

www.abelectric.bg
www.abenergygroup.bg

Covers of Cable Trays and Accessories

Капази на кабелни скари и аксесоари

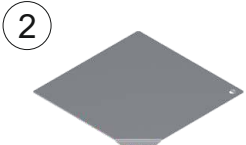
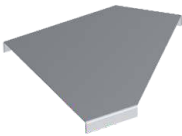

Аксесоари

<p>Cover of Cable Tray Капак на кабелна скарата</p>  <p>FKK / KK</p>	<p>90° Hor. bend cover Капак на 90° Хоризонтална ъглова чупка на кабелна скара</p>  <p>KK90</p>	<p>45° Hor. bend cover Капак на 45° Хоризонтална ъглова чупка на кабелна скара</p>  <p>KK45</p>	<p>Tee bend cover Капак на Т-образна хоризонтална ъглова чупка на кабелна скарата</p>  <p>KKT</p>
<p>Cover clamp Скоба за капак</p>  <p>KT/1</p>	<p>Ver. inside bend cover Капак на вертикално вътрешно огъване на кабелна скара (гъвкав)</p>  <p>KKIB</p>	<p>Ver. outside bend cover Капак на вертикално външно огъване на кабелна скара (гъвкав)</p>  <p>KKDB</p>	<p>Cross bend cover Капак на кръстосано огъване</p>  <p>KKD</p>

Cover of Cable Tray

Капак на кабелна скара

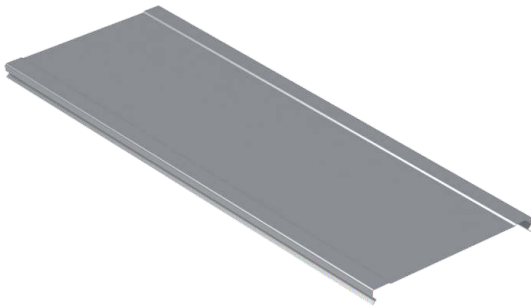

FKK

APPLICATIONS
Cable routing

MATERIAL
Steel, strip-galv. acc. to the Sendzimir method to TS-EN 10346:2011 (PG)

Available finishes:
HDG-steel, hot-dip galv. to TS-EN ISO 1461:2011 (HDG)
SS- stainless steel AISI 304L and AISI 316L (SS)
EP- powder coating in a full range of colours (RAL)

Thickn. (ga) [mm]: 0.6 0.8 1.0 1.2

Important!
Joining cable tray sections together only use
Screw Sets CFS M6 or CFS M8

Pre - Galvanised

FKK ...		0.6mm			
CODE	Width a mm	Length L mm	kg 1 pc	pcs	
FKK 05 06 PG	50	3000	0.38	2	
FKK 07 06 PG	75	3000	0.50	2	
FKK 10 06 PG	100	3000	0.62	2	
FKK 12 06 PG	125	3000	0.74	2	
FKK 15 06 PG	150	3000	0.85	2	
FKK 20 06 PG	200	3000	1.09	2	
		0.7mm			
FKK 05 07 PG	50	3000	0.44	2	
FKK 07 07 PG	75	3000	0.58	2	
FKK 10 07 PG	100	3000	0.72	2	
FKK 12 07 PG	125	3000	0.86	2	
FKK 15 07 PG	150	3000	0.99	2	
FKK 20 07 PG	200	3000	1.27	2	
		0.8mm			
FKK 05 08 PG	50	3000	0.51	2	
FKK 07 08 PG	75	3000	0.66	2	
FKK 10 08 PG	100	3000	0.82	2	
FKK 12 08 PG	125	3000	0.98	2	
FKK 15 08 PG	150	3000	1.14	2	
FKK 20 08 PG	200	3000	1.45	2	
FKK 22 08 PG	225	3000	1.61	2	
FKK 25 08 PG	250	3000	1.76	2	
FKK 30 08 PG	300	3000	2.08	2	

FKK		1.0mm			
CODE	Width a mm	Length L mm	kg 1 pc	pcs	
FKK 05 10 PG	50	3000	0.63	2	
FKK 07 10 PG	75	3000	0.83	2	
FKK 10 10 PG	100	3000	1.03	2	
FKK 12 10 PG	125	3000	1.22	2	
FKK 15 10 PG	150	3000	1.42	2	
FKK 20 10 PG	200	3000	1.81	2	
FKK 22 10 PG	225	3000	2.01	2	
FKK 25 10 PG	250	3000	2.20	2	
FKK 30 10 PG	300	3000	2.60	2	
FKK 40 10 PG	400	3000	3.38	2	
FKK 45 10 PG	450	3000	3.60	2	
FKK 50 10 PG	500	3000	4.00	2	
FKK 60 10 PG	600	3000	4.75	2	
		1.2mm			
FKK 05 12 PG	50	3000	0.76	2	
FKK 07 12 PG	75	3000	0.99	2	
FKK 10 12 PG	100	3000	1.23	2	
FKK 12 12 PG	125	3000	1.47	2	
FKK 15 12 PG	150	3000	1.70	2	
FKK 20 12 PG	200	3000	2.17	2	
FKK 22 12 PG	225	3000	2.41	2	
FKK 25 12 PG	250	3000	2.64	2	
FKK 30 12 PG	300	3000	3.11	2	
FKK 40 12 PG	400	3000	4.06	2	
FKK 45 12 PG	450	3000	4.53	2	
FKK 50 12 PG	500	3000	5.00	2	
FKK 60 12 PG	600	3000	5.94	2	

		0.5mm			
CODE	Width a mm	Length L mm	kg 1 pc	pcs	
FKK 05 05 PG	50	3000	0.31	2	
FKK 10 05 PG	100	3000	0.51	2	

Mounting Example

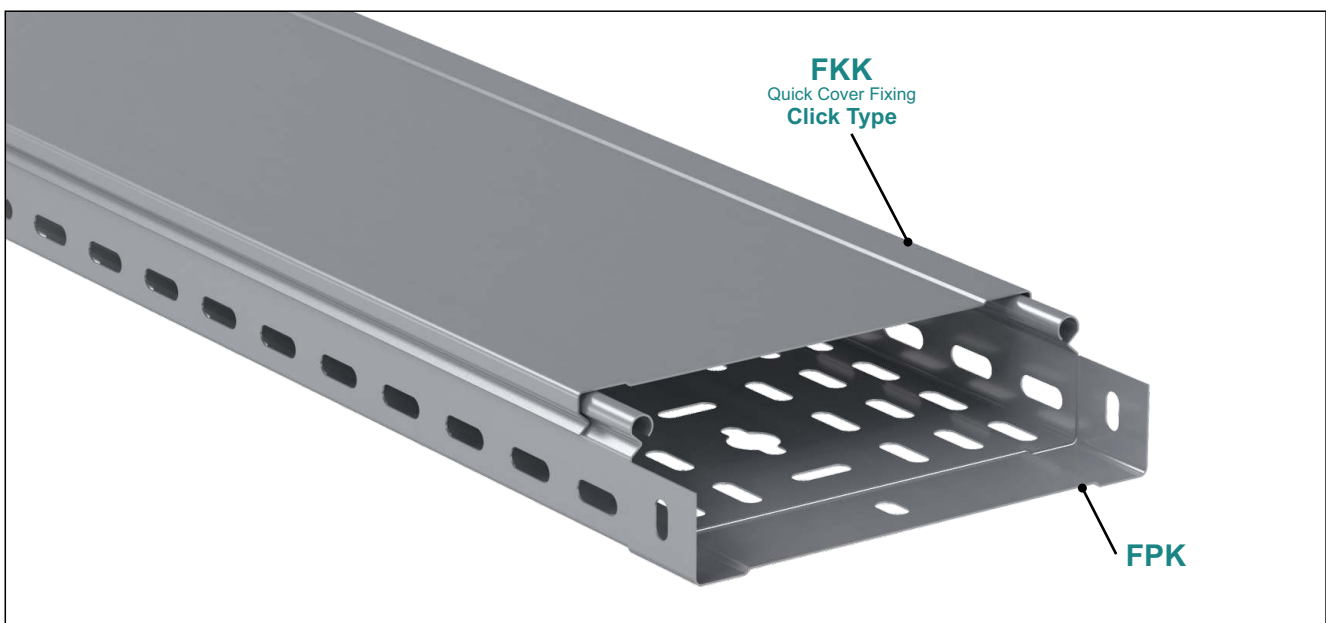

Cover of Cable Tray / Ladder

Капак на кабелна скара / стълба

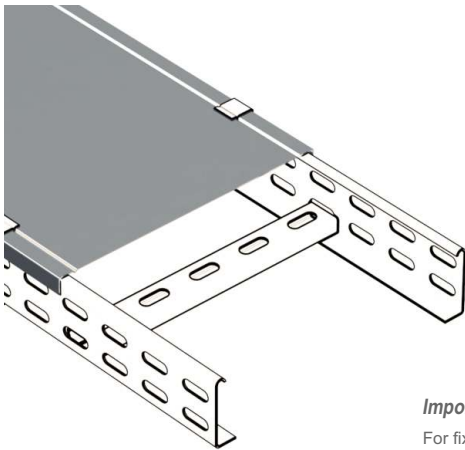

Important!

For fixing cable tray cover sections use 4 pcs of KT/1 cover clamps for 1 length

Pre - Galvanised

KK ...	0.6mm			
CODE	Width W mm	Length L mm	Kg 1 mt	pcs
KK 05 06 PG	50	3000	0.38	2
KK 07 06 PG	75	3000	0.50	2
KK 10 06 PG	100	3000	0.62	2
KK 12 06 PG	125	3000	0.74	2
KK 15 06 PG	150	3000	0.85	2
KK 20 06 PG	200	3000	1.09	2
KK ...	0.8mm			
KK 05 08 PG	50	3000	0.51	2
KK 07 08 PG	75	3000	0.66	2
KK 10 08 PG	100	3000	0.82	2
KK 12 08 PG	125	3000	0.98	2
KK 15 08 PG	150	3000	1.14	2
KK 20 08 PG	200	3000	1.45	2
KK 22 08 PG	225	3000	1.61	2
KK 25 08 PG	250	3000	1.76	2
KK 30 08 PG	300	3000	2.08	2
KK ...	1.0mm			
KK 05 10 PG	50	3000	0.63	2
KK 07 10 PG	75	3000	0.83	2
KK 10 10 PG	100	3000	1.03	2
KK 12 10 PG	125	3000	1.22	2
KK 15 10 PG	150	3000	1.42	2
KK 20 10 PG	200	3000	1.81	2
KK 22 10 PG	225	3000	2.01	2
KK 25 10 PG	250	3000	2.20	2
KK 30 10 PG	300	3000	2.60	2
KK 40 10 PG	400	3000	3.38	2

KK ...	1.2mm			
CODE	Width W mm	Length L mm	Kg 1 mt	pcs
KK 05 12 PG	50	3000	0.76	2
KK 07 12 PG	75	3000	0.99	2
KK 10 12 PG	100	3000	1.23	2
KK 12 12 PG	125	3000	1.47	2
KK 15 12 PG	150	3000	1.70	2
KK 20 12 PG	200	3000	2.17	2
KK 22 12 PG	225	3000	2.41	2
KK 25 12 PG	250	3000	2.64	2
KK 30 12 PG	300	3000	3.11	2
KK 40 12 PG	400	3000	4.06	2
KK 45 12 PG	450	3000	4.53	2
KK 50 12 PG	500	3000	5.00	2
KK 60 12 PG	600	3000	5.94	2
KK ...	1.5mm			
KK 05 15 PG	50	3000	0.95	2
KK 07 15 PG	75	3000	1.24	2
KK 10 15 PG	100	3000	1.54	2
KK 12 15 PG	125	3000	1.83	2
KK 15 15 PG	150	3000	2.12	2
KK 20 15 PG	200	3000	2.71	2
KK 22 15 PG	225	3000	3.01	2
KK 25 15 PG	250	3000	3.30	2
KK 30 15 PG	300	3000	3.89	2
KK 40 15 PG	400	3000	5.07	2
KK 45 15 PG	450	3000	5.66	2
KK 50 15 PG	500	3000	6.25	2
KK 60 15 PG	600	3000	7.42	2

KK

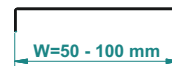
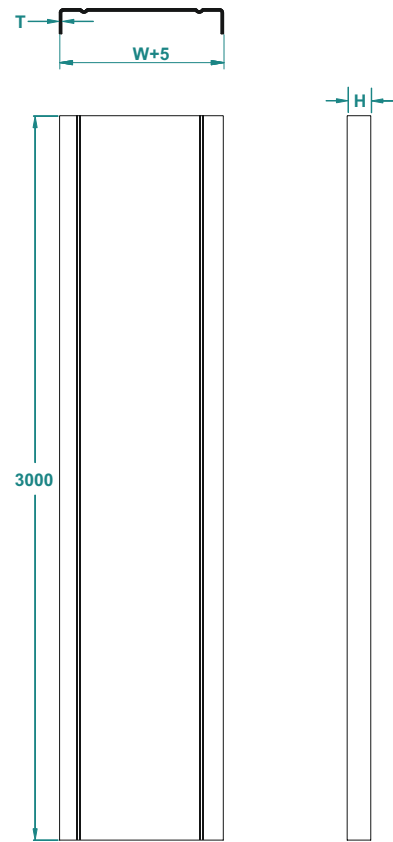

Standard



Reinforced

Cover Clamp

Скоба за капак - Тип KT/1

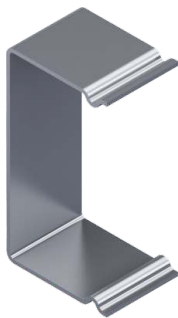

Pre - Galvanised

KT/1 ...	1.2mm		
CODE	H mm	Kg 1 pc	pcs
KT/1 40 PG	40	0.031	100
KT/1 50 PG	50	0.034	100
KT/1 60 PG	60	0.037	100
KT/1 80 PG	80	0.034	100
KT/1 100 PG	100	0.037	100

KT/1

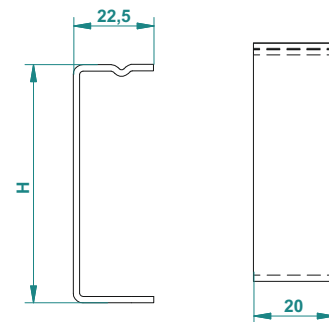

APPLICATIONS
Cable routing

MATERIAL
Steel, strip-galv. acc. to the Sendzimir method to TS-EN 10346:2011 (PG)

Available finishes:
HDG-steel, hot-dip galv. to TS-EN ISO 1461:2011 (HDG)
SS- stainless steel AISI 304L and AISI 316L (SS)
EP- powder coating in a full range of colours (RAL)

Thickn. (ga) [mm]: **0.6 | 0.8 | 1.0 | 1.2 | 1.5**

Cover of 90° Horizontal Bend of Cable Tray

Капак на 90° Хоризонтална ъглова чупка на кабелна скара

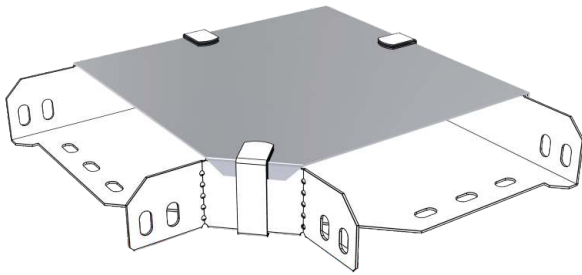

Important!

For fixing cable tray cover bend sections use 3 pcs of KT/1 cover clamps. Cover clamps fixing - side sliding.

Pre - Galvanized

KK90 ...		0.8mm	
CODE	Width a=b mm	kg 1 pc	pcs
KK90 05 08 PG	50	0.08	1
KK90 07 08 PG	75	0.12	1
KK90 10 08 PG	100	0.16	1
KK90 12 08 PG	125	0.22	1
KK90 15 08 PG	150	0.28	1
KK90 20 08 PG	200	0.44	1
		1.0mm	
CODE	Width a=b mm	kg 1 pc	pcs
KK90 05 10 PG	50	0.10	1
KK90 07 10 PG	75	0.15	1
KK90 10 10 PG	100	0.21	1
KK90 12 10 PG	125	0.28	1
KK90 15 10 PG	150	0.36	1
KK90 20 10 PG	200	0.55	1
KK90 22 10 PG	225	0.66	1
KK90 25 10 PG	250	0.78	1
KK90 30 10 PG	300	1.00	1
KK90 40 10 PG	400	1.62	1

KK90 ...		1.2mm	
CODE	Width a=b mm	kg 1 pc	pcs
KK90 30 12 PG	300	1.25	1
KK90 40 12 PG	400	2.03	1
KK90 45 12 PG	450	2.49	1
KK90 50 12 PG	500	3.00	1
KK90 60 12 PG	600	4.16	1
		1.5mm	
CODE	Width a=b mm	kg 1 pc	pcs
KK90 05 15 PG	50	0.15	1
KK90 07 15 PG	75	0.23	1
KK90 10 15 PG	100	0.32	1
KK90 12 15 PG	125	0.42	1
KK90 15 15 PG	150	0.54	1
KK90 20 15 PG	200	0.82	1
KK90 22 15 PG	225	0.99	1
KK90 25 15 PG	250	1.16	1
KK90 30 15 PG	300	1.56	1
KK90 40 15 PG	400	2.54	1
KK90 45 15 PG	450	3.12	1
KK90 50 15 PG	500	3.75	1
KK90 60 15 PG	600	5.20	1

KK90

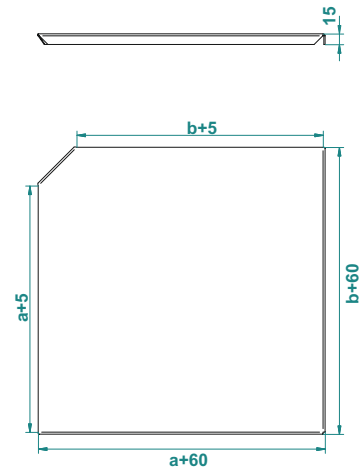

Cover of 45° Horizontal Bend of Cable Tray

Капак на 45° Хоризонтална ъглова чупка на кабелна скара.

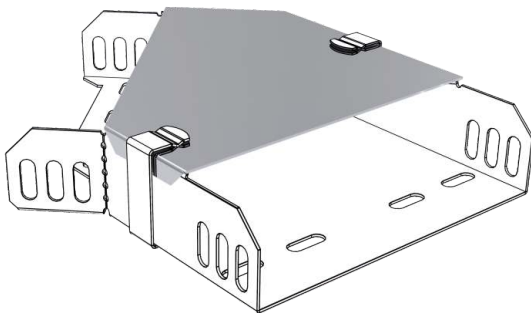

Important!

For fixing cable tray cover bend sections use 2 pcs of KT/1 cover clamps. Cover clamps fixing - side sliding.

Pre - Galvanized

KK45 ...		0.8mm	
CODE	Width a=b mm	kg 1 pc	pcs
KK45 05 08 PG	50	0.06	1
KK45 07 08 PG	75	0.08	1
KK45 10 08 PG	100	0.12	1
KK45 12 08 PG	125	0.16	1
KK45 15 08 PG	150	0.21	1
KK45 20 08 PG	200	0.32	1
		1.0mm	
CODE	Width a=b mm	kg 1 pc	pcs
KK45 05 10 PG	50	0.08	1
KK45 07 10 PG	75	0.11	1
KK45 10 10 PG	100	0.16	1
KK45 12 10 PG	125	0.21	1
KK45 15 10 PG	150	0.27	1
KK45 20 10 PG	200	0.41	1
KK45 22 10 PG	225	0.49	1
KK45 25 10 PG	250	0.58	1
KK45 30 10 PG	300	0.74	1
KK45 40 10 PG	400	1.20	1

KK45 ...		1.2mm	
CODE	Width a=b mm	kg 1 pc	pcs
KK45 30 12 PG	300	0.92	1
KK45 40 12 PG	400	1.49	1
KK45 45 12 PG	450	1.82	1
KK45 50 12 PG	500	2.19	1
KK45 60 12 PG	600	3.02	1
		1.5mm	
CODE	Width a=b mm	kg 1 pc	pcs
KK45 05 15 PG	50	0.11	1
KK45 07 15 PG	75	0.17	1
KK45 10 15 PG	100	0.24	1
KK45 12 15 PG	125	0.32	1
KK45 15 15 PG	150	0.40	1
KK45 20 15 PG	200	0.61	1
KK45 22 15 PG	225	0.73	1
KK45 25 15 PG	250	0.86	1
KK45 30 15 PG	300	1.15	1
KK45 40 15 PG	400	1.86	1
KK45 45 15 PG	450	2.28	1
KK45 50 15 PG	500	2.74	1
KK45 60 15 PG	600	3.78	1

KK45

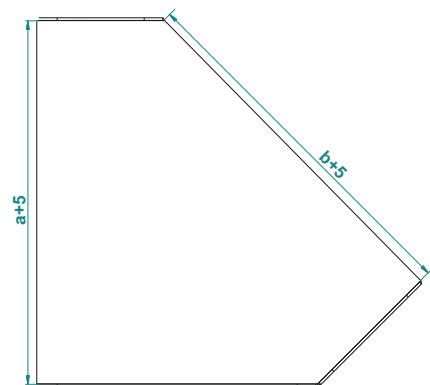

APPLICATIONS

Cable routing

MATERIAL

Steel, strip-galv. acc. to the Sendzimir method to TS-EN 10346:2011 (PG)

Available finishes:

HDG-steel, hot-dip galv. to TS-EN ISO 1461:2011 (HDG)

SS- stainless steel AISI 304L and AISI 316L (SS)

EP- powder coating in a full range of colours (RAL)

Thickn. (ga) [mm]:

0.6 0.8 1.0 1.2 1.5

Cover of Horizontal Bend of Cable Tray

Капак на Т-образна хоризонтална ъглова чупка на кабелна скарата.

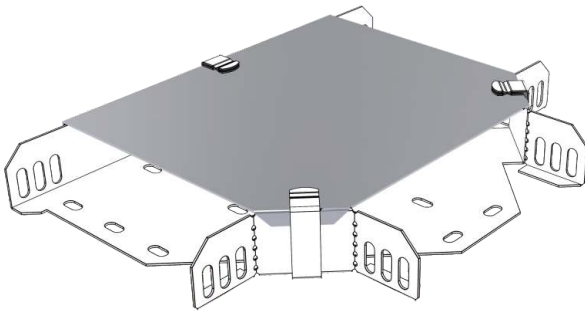

Important!

For fixing cable tray cover bend sections use 3 pcs of KT/1 cover clamps. Cover clamps fixing - side sliding.

Pre - Galvanised

KKT ...		0.8mm	
CODE	Width a=b=c mm	1 pc	pcs
KKT 05 08 PG	50	0.10	1
KKT 07 08 PG	75	0.15	1
KKT 10 08 PG	100	0.20	1
KKT 12 08 PG	125	0.26	1
KKT 15 08 PG	150	0.33	1
KKT 20 08 PG	200	0.49	1
KKT ...		1.0mm	
CODE	Width a=b=c mm	1 pc	pcs
KKT 05 10 PG	50	0.13	1
KKT 07 10 PG	75	0.19	1
KKT 10 10 PG	100	0.26	1
KKT 12 10 PG	125	0.33	1
KKT 15 10 PG	150	0.42	1
KKT 20 10 PG	200	0.62	1
KKT 22 10 PG	225	0.74	1
KKT 25 10 PG	250	0.86	1
KKT 30 10 PG	300	1.10	1
KKT 40 10 PG	400	1.74	1

KKT ...		1.2mm	
CODE	Width a=b=c mm	1 pc	pcs
KKT 30 12 PG	300	1.37	1
KKT 40 12 PG	400	2.18	1
KKT 45 12 PG	450	2.66	1
KKT 50 12 PG	500	3.19	1
KKT 60 12 PG	600	4.38	1
KKT ...		1.5mm	
CODE	Width a=b=c mm	1 pc	pcs
KKT 05 15 PG	50	0.20	1
KKT 07 15 PG	75	0.29	1
KKT 10 15 PG	100	0.39	1
KKT 12 15 PG	125	0.50	1
KKT 15 15 PG	150	0.63	1
KKT 20 15 PG	200	0.93	1
KKT 22 15 PG	225	1.10	1
KKT 25 15 PG	250	1.29	1
KKT 30 15 PG	300	1.71	1
KKT 40 15 PG	400	2.73	1
KKT 45 15 PG	450	3.33	1
KKT 50 15 PG	500	3.98	1
KKT 60 15 PG	600	5.47	1

KKT

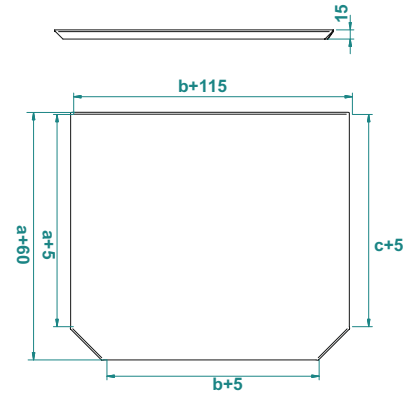

Cover of Cross Bend of Cable Tray

Капак на кръстосано огъване

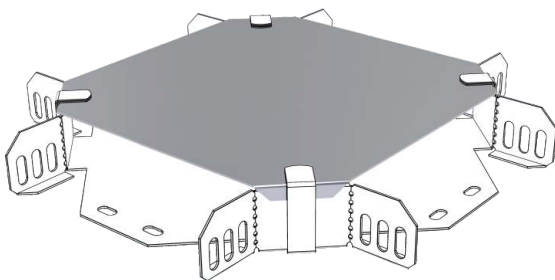

Important!

For fixing cable tray cover bend sections use 4 pcs of KT/1 cover clamps. Cover clamps fixing - side sliding.

Pre - Galvanised

KKD ...		0.8mm	
CODE	Width a=b=c=d mm	1 pc	pcs
KKD 05 10 PG	50	0.13	1
KKD 07 10 PG	75	0.19	1
KKD 10 10 PG	100	0.24	1
KKD 12 10 PG	125	0.31	1
KKD 15 10 PG	150	0.39	1
KKD 20 10 PG	200	0.56	1
KKD ...		1.0mm	
CODE	Width a=b=c=d mm	1 pc	pcs
KKD 05 10 PG	50	0.17	1
KKD 07 10 PG	75	0.24	1
KKD 10 10 PG	100	0.31	1
KKD 12 10 PG	125	0.39	1
KKD 15 10 PG	150	0.49	1
KKD 20 10 PG	200	0.70	1
KKD 22 10 PG	225	0.82	1
KKD 25 10 PG	250	0.96	1
KKD 30 10 PG	300	1.20	1
KKD 40 10 PG	400	1.88	1

KKD ...		1.2mm	
CODE	Width a=b=c=d mm	1 pc	pcs
KKD 30 12 PG	300	1.50	1
KKD 40 12 PG	400	2.35	1
KKD 45 12 PG	450	2.84	1
KKD 50 12 PG	500	3.38	1
KKD 60 12 PG	600	4.60	1
KKD ...		1.5mm	
CODE	Width a=b=c=d mm	1 pc	pcs
KKD 05 15 PG	50	0.26	1
KKD 07 15 PG	75	0.36	1
KKD 10 15 PG	100	0.47	1
KKD 12 15 PG	125	0.59	1
KKD 15 15 PG	150	0.73	1
KKD 20 15 PG	200	1.05	1
KKD 22 15 PG	225	1.24	1
KKD 25 15 PG	250	1.43	1
KKD 30 15 PG	300	1.87	1
KKD 40 15 PG	400	2.93	1
KKD 45 15 PG	450	3.55	1
KKD 50 15 PG	500	4.22	1
KKD 60 15 PG	600	5.75	1

KKD

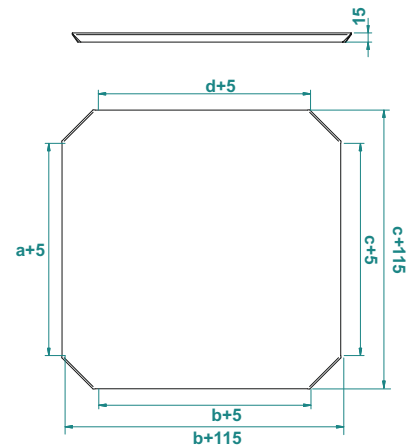

APPLICATIONS

Cable routing

MATERIAL

Steel, strip-galv. acc. to the Sendzimir method to TS-EN 10346:2011 (PG)

Available finishes:

HDG-steel, hot-dip galv. to TS-EN ISO 1461:2011 (HDG)

SS- stainless steel AISI 304L and AISI 316L (SS)

EP- powder coating in a full range of colours (RAL)

Thickn. (ga) [mm]: **0.6** **0.8** **1.0** **1.2** **1.5**

Cover of Vertical Outside Bend of Cable Tray (Flexible)

Капак на вертикално външно огъване на кабелна скара (гъвкав)

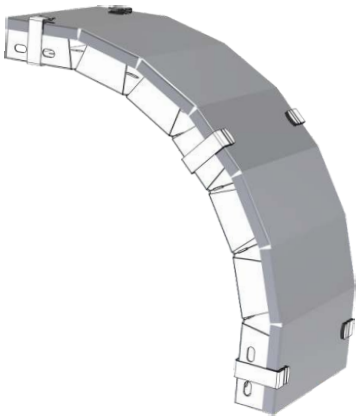

Pre - Galvanised

KKDB ... H15				0.8mm	
CODE	Width a mm	KG 1 pc	pcs		
KKDB 05 08 PG	50	0.32	1		
KKDB 07 08 PG	75	0.41	1		
KKDB 10 08 PG	100	0.51	1		
KKDB 12 08 PG	125	0.61	1		
KKDB 15 08 PG	150	0.71	1		
KKDB 20 08 PG	200	1.90	1		
KKDB ... H15				1.0mm	
CODE	Width a mm	KG 1 pc	pcs		
KKDB 05 10 PG	50	0.40	1		
KKDB 07 10 PG	75	0.52	1		
KKDB 10 10 PG	100	0.64	1		
KKDB 12 10 PG	125	0.77	1		
KKDB 15 10 PG	150	0.89	1		
KKDB 20 10 PG	200	1.13	1		
KKDB 22 10 PG	225	1.26	1		
KKDB 25 10 PG	250	1.38	1		
KKDB 30 10 PG	300	1.56	1		
KKDB 40 10 PG	400	2.43	1		

Important!

For fixing cable tray cover bend sections use 4 pcs of KT/1 cover clamps. Cover clamps fixing - side sliding.

KKDB ... H15				1.2mm	
CODE	Width a mm	KG 1 pc	pcs		
KKDB 30 12 PG	300	1.95	1		
KKDB 40 12 PG	400	3.04	1		
KKDB 45 12 PG	450	3.40	1		
KKDB 50 12 PG	500	3.75	1		
KKDB 60 12 PG	600	4.46	1		
KKDB ... H15				1.5mm	
CODE	Width a mm	KG 1 pc	pcs		
KKDB 05 15 PG	50	0.59	1		
KKDB 07 15 PG	75	0.78	1		
KKDB 10 15 PG	100	0.96	1		
KKDB 12 15 PG	125	1.15	1		
KKDB 15 15 PG	150	1.33	1		
KKDB 20 15 PG	200	1.70	1		
KKDB 22 15 PG	225	1.88	1		
KKDB 25 15 PG	250	2.07	1		
KKDB 30 15 PG	300	2.43	1		
KKDB 40 15 PG	400	3.80	1		
KKDB 45 15 PG	450	4.24	1		
KKDB 50 15 PG	500	4.69	1		
KKDB 60 15 PG	600	5.57	1		

KKDB

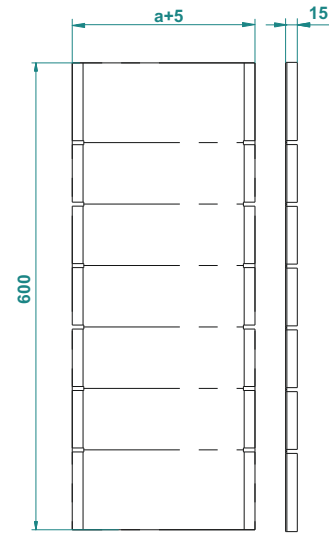

Cover of Vertical Inside Bend of Cable Tray (Flexible)

Капак на вертикално вътрешно огъване на кабелна скарата (гъвкав)



Pre - Galvanized

KKIB ... H15				0.8mm	
CODE	Width a mm	KG 1 pc	pcs		
KKIB 05 08 PG	50	0.32	1		
KKIB 07 08 PG	75	0.41	1		
KKIB 10 08 PG	100	0.51	1		
KKIB 12 08 PG	125	0.61	1		
KKIB 15 08 PG	150	0.71	1		
KKIB 20 08 PG	200	1.90	1		
KKIB ... H15				1.0mm	
CODE	Width a mm	KG 1 pc	pcs		
KKIB 05 10 PG	50	0.40	1		
KKIB 07 10 PG	75	0.52	1		
KKIB 10 10 PG	100	0.64	1		
KKIB 12 10 PG	125	0.77	1		
KKIB 15 10 PG	150	0.89	1		
KKIB 20 10 PG	200	1.13	1		
KKIB 22 10 PG	225	1.26	1		
KKIB 25 10 PG	250	1.38	1		
KKIB 30 10 PG	300	1.56	1		
KKIB 40 10 PG	400	2.43	1		

Important!

For fixing cable tray cover bend sections use 4 pcs of KT/1 cover clamps. Cover clamps fixing - side sliding.

KKIB ... H15				1.2mm	
CODE	Width a mm	KG 1 pc	pcs		
KKIB 30 12 PG	300	1.95	1		
KKIB 40 12 PG	400	3.04	1		
KKIB 45 12 PG	450	3.40	1		
KKIB 50 12 PG	500	3.75	1		
KKIB 60 12 PG	600	4.46	1		
KKIB ... H15				1.5mm	
CODE	Width a mm	KG 1 pc	pcs		
KKIB 05 15 PG	50	0.59	1		
KKIB 07 15 PG	75	0.78	1		
KKIB 10 15 PG	100	0.96	1		
KKIB 12 15 PG	125	1.15	1		
KKIB 15 15 PG	150	1.33	1		
KKIB 20 15 PG	200	1.70	1		
KKIB 22 15 PG	225	1.88	1		
KKIB 25 15 PG	250	2.07	1		
KKIB 30 15 PG	300	2.43	1		
KKIB 40 15 PG	400	3.80	1		
KKIB 45 15 PG	450	4.24	1		
KKIB 50 15 PG	500	4.69	1		
KKIB 60 15 PG	600	5.57	1		

KKIB

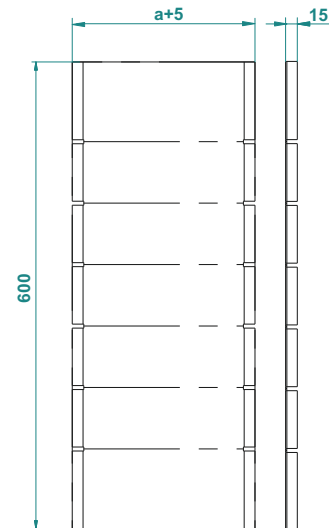

APPLICATIONS

Cable routing

MATERIAL

Steel, strip-galv. acc. to the Sendzimir method to TS-EN 10346:2011 (PG)

Available finishes:

HDG-steel, hot-dip galv. to TS-EN ISO 1461:2011 (HDG)
SS- stainless steel AISI 304L and AISI 316L (SS)
EP- powder coating in a full range of colours (RAL)

Thickn. (ga) [mm]: **0.6 0.8 1.0 1.2 1.5**

Cable Tray Covers



ЕНЕРДЖИ ГРУП ООД

Cover of Add On Tee Horizontal Bend of Cable Tray

Капак на Т-образна хоризонтална ъглова чупка на кабелна скарата.

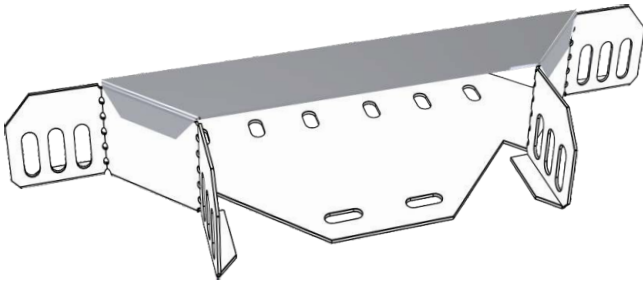

Important!

For fixing cable tray cover bend sections use 2 pcs of KT/1 cover clamps. Cover clamps fixing - side sliding.

Pre - Galvanised

KKTE ... H15		0.8mm	
CODE	Width a mm	kg 1 pc	pcs
KKTE 15 10 PG	100	0.08	1
KKTE 20 10 PG	125	1.00	1
KKTE 22 10 PG	150	0.13	1
KKTE 25 10 PG00		0.14	1
		1.0mm	
KKTE 15 10 PG	100	0.10	1
KKTE 20 10 PG	125	0.12	1
KKTE 22 10 PG	150	0.13	1
KKTE 25 10 PG	200	0.14	1
KKTE 30 10 PG	250	0.15	1
KKTE 40 10 PG	300	0.16	1

KKTE ... H15		1.2mm	
CODE	Width a mm	kg 1 pc	pcs
KKTE 30 12 PG	300	0.19	1
KKTE 40 12 PG	400	0.23	1
KKTE 45 12 PG	450	0.26	1
KKTE 50 12 PG	500	0.28	1
KKTE 60 12 PG	600	0.33	1
		1.5mm	
KKTER1 15 15 PG	100	0.45	1
KKTER1 20 15 PG	125	0.51	1
KKTER1 22 15 PG	150	0.55	1
KKTER1 25 15 PG	200	0.58	1
KKTER1 30 15 PG	225	0.64	1
KKTER1 40 15 PG	250	0.76	1
KKTER1 45 15 PG	300	0.83	1
KKTER1 50 15 PG	400	0.89	1
KKTER1 60 15 PG	450	1.01	1

KKTE

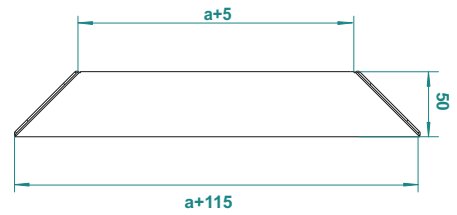

APPLICATIONS

Cable routing

MATERIAL

Steel, strip-galv. acc. to the Sendzimir method to TS-EN 10346:2011 (PG)

Available finishes:

HDG-steel, hot-dip galv. to TS-EN ISO 1461:2011 (HDG)

SS- stainless steel AISI 304L and AISI 316L (SS)

EP- powder coating in a full range of colours (RAL)

Thickn. (ga) [mm]:

0.6 | 0.8 | 1.0 | 1.2 | 1.5

Edge Protection Strip

Защитна лента за ръбове

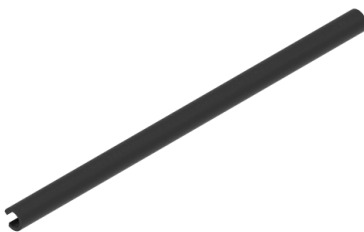

FIT SNG



FIT DBL

PVC

FIT ...			
CODE	Length L mt	kg mt/kg	pcs
FIT SNG	10	0.10	1

FIT ...			
CODE	Length L mt	kg mt/kg	pcs
FIT DBL	10	0.20	1

Zinc Spray

Цинков спрей



CODE	kg 1pc	pcs
ZINC 400	0.4	1

Zinc Repair Paint

Ремонтна цинкова боя



CODE	kg 1pc	pcs
ZINC PAS	1.0	1

FIT SNG

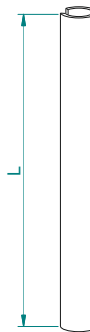

FIT DBL

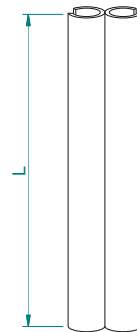

APPLICATIONS

Cable routing / Standard : IEC 61537

Cable Tray Covers and Accessories

Огъвания и аксесоари за кабелни скари

Cover of 90° Horizontal Bend



**KK90R1
R150°**

Cover of 90° Horizontal Bend



**KK90R2 - KK90R4
R300 - R600**

Cover of Horizontal Adjustable Bends



KK90H 15-90°

Cover of 45° Horizontal Bend

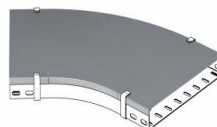

**KK45R2 - KK45R4
R300 - R600**

Wrap Around Cover Clamp

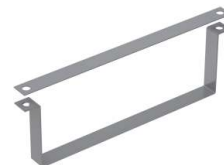

KT/2

Cover of Middle Reducer Bend

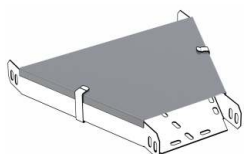

RKOS

Cover of Left Reducer Bend



RKLS

Cover of Left Reducer Bend

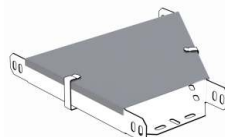

RKGS

Cover of Tee Horizontal Bend

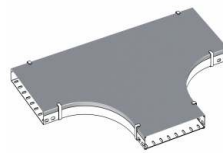

**KKTR2 - KKTR4
R300 - R600**

Cover of Cross Bend

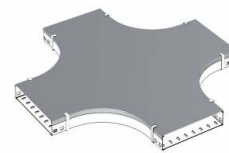

**KKDR2 - KKDR4
R300 - R600**

Cover of Vertical 90° Inside Bend



KKIS

Cover Vertical 90° Outside Bend



KKDS

Cover of Vertical 45° Outside Bend

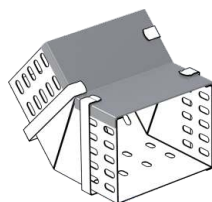

KKIS45

Cover of Vertical 45° Outside Bend

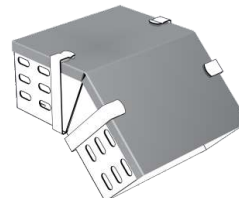

KKDS45

Peaked Cover of Cable Tray / Ladder

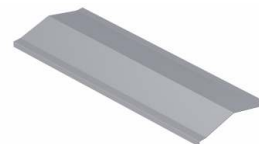

KKC

Cover of Vertical 90° Inside Bend



**KKISR2 - KKISR4
R300 - R600**

Cover of Vertical 90° Outside Bend



**KKDSR2 - KKDSR4
R300 - R600**

Cover of Vertical 45° Inside Bend

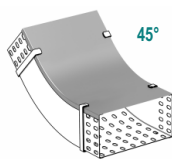

**KKIS45R2 - KKIS45R4
R300 - R600**

Cover of Vertical 45° Outside Bend

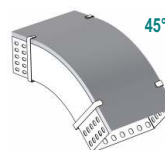

**KKDS45R2 - KKDS45R4
R300 - R600**

Louvered Cover of Cable Tray / Ladder



KKP

Cover of Vertical Tee Bend

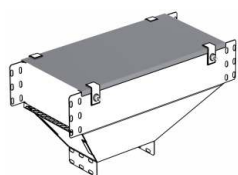

KKDT

Cover of Vertical Tee Bend

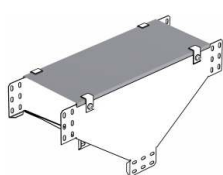

KKMT

Cover of Vertical Tee Bend

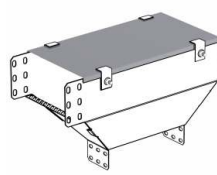

KKDL

Cover of Vertical Elbow

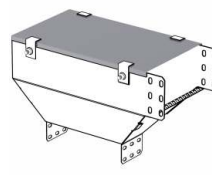

KKDG

Peaked Type Wrap Cover Clamp



KT/3